

# ParkRidge Four

10375 ParkMeadows Drive, Lone Tree, CO 80124

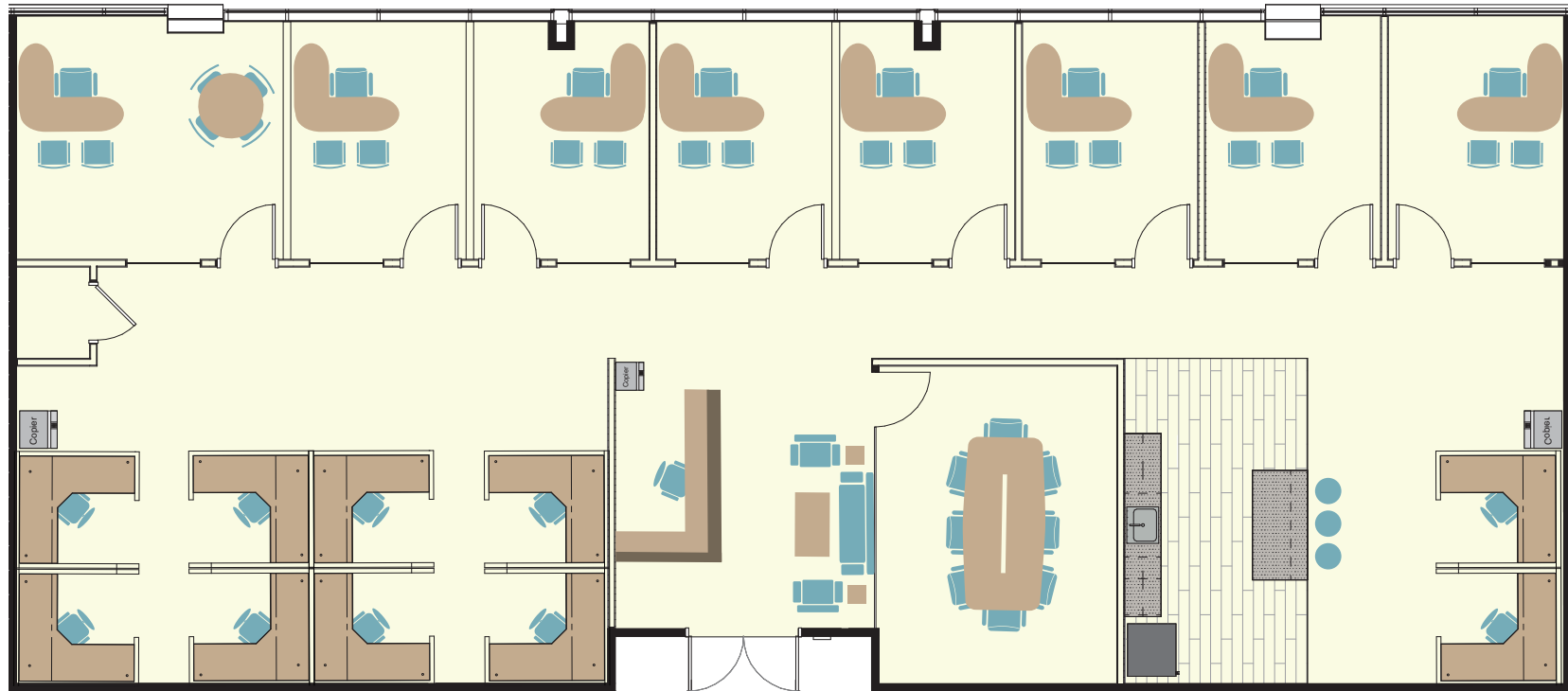

(Under Construction)



## SPEC SUITE 240 - 3,523 SF

For leasing information please contact:

Matt Smith | 303.996.8460

[msmith@premisescommercial.com](mailto:msmith@premisescommercial.com)

Michelle Gertzman | 720.743.6399

[mgertzman@premisescommercial.com](mailto:mgertzman@premisescommercial.com)